

Scale 1:96

LTV Scout B

An all solid fuel launch vehicle and NASA's small satellite launcher from 1959 to 1994.

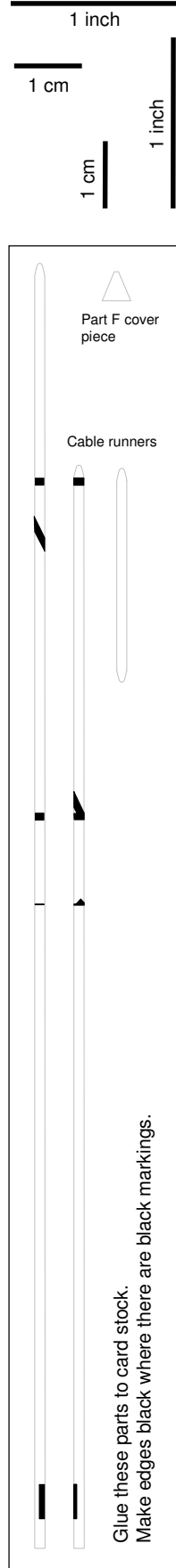
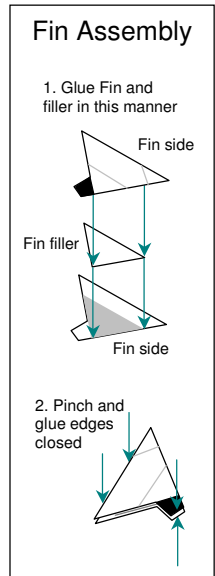
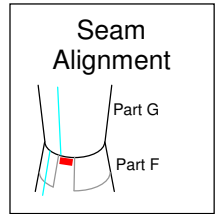
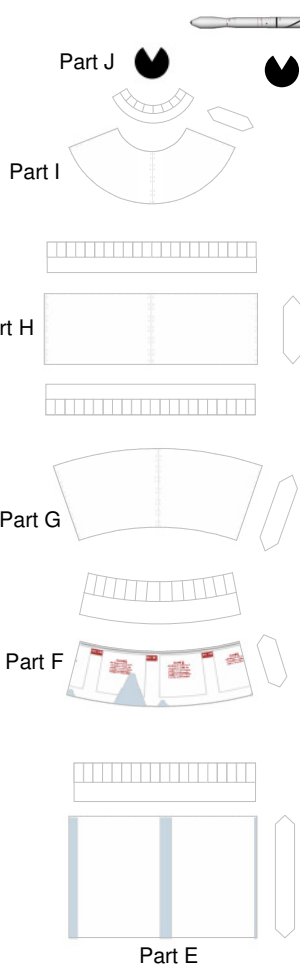
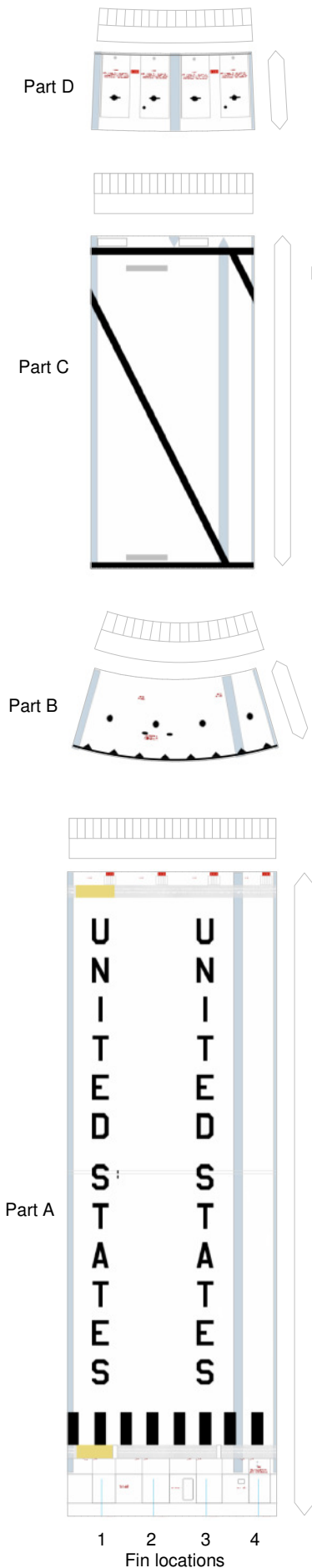

Assembly Instructions

1. Assemble parts A-E and set aside to dry.
2. Assemble parts F-J and set aside to dry. Align seams as shown.
3. Assemble engine as shown below.
4. Glue AE subassembly to FJ subassembly.
5. Slide and glue in engine in to part A.
6. Attach cable runners and part F cover to shaded areas.
7. Assemble fins and glue as indicated on the guide.

Engine Assembly

1. Roll and glue part Z2 into a cylinder with printing on the inside. Making sure it fits snugly into part A. Fold glue tabs down.

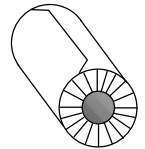

2. Glue part Z1 inside, with printing on the inside.

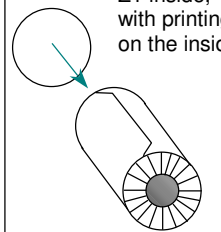

3. Roll part Z3 into a cone with printing on the inside. Glue inside engine housing. Glue part Z4 over the glue tabs for part Z3.

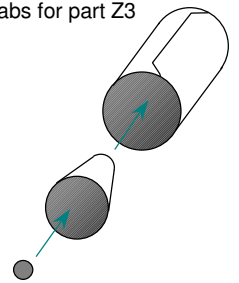

4. Slide completed assembly into bottom of part A.